

Copying of this document and giving it to others, and the use or communication of the contents thereof, are forbidden without express authority. All rights reserved.

Weitergabe und Vervielfältigung dieser Unterlage, sowie Verwertung und Mitteilung ihres Inhalts nicht gestattet, soweit nicht ausdrücklich zugestanden. Alle Rechte vorbehalten

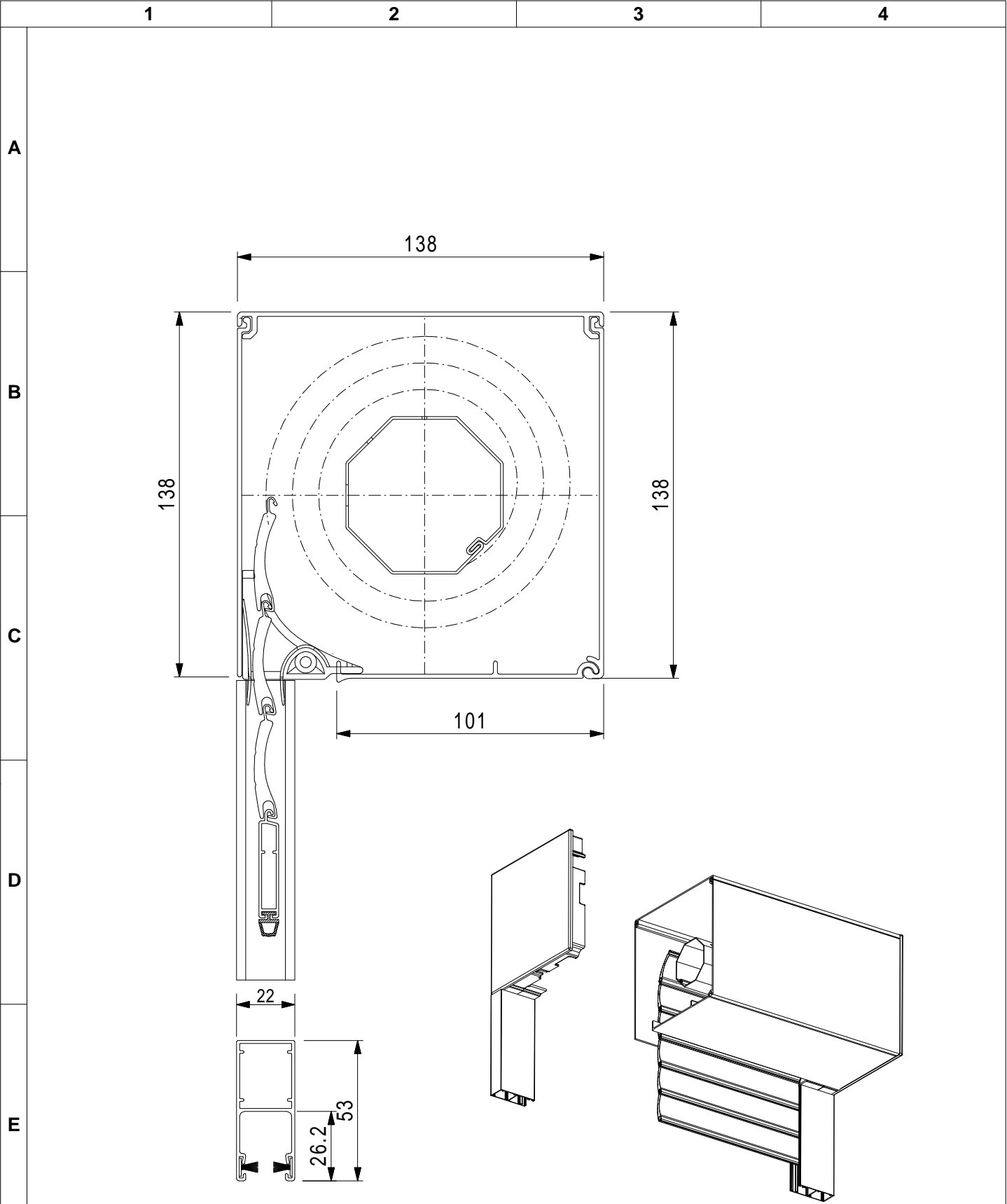

<div>ALULUX®</div> <div>Alulux GmbH Messingstraße 16 D-33415 Verl</div>		<div>Maße in mm Dimensions in millimeters</div> <div></div>		<div>Zul. Abw. f. Maße ohne Toleranzang. General tolerances</div> <div>DIN ISO 2768 cK</div>		<div>Fertigzustand finished cond.</div> <div>-</div>		<div>Maßstab Scale 1:2</div>		<div>Menge Quantity</div> <div>-</div>			
								<div>Werkstoff/material</div> <div>Aluminium</div>		<div>Fläche/face (mm²)</div> <div>-</div>			
								<div>U-Kreis (mm)</div> <div>-</div>		<div>Abwickl. Außen/ext. dev. drawing(mm)</div> <div>-</div>			
								<div>Gewicht/weight</div> <div>-</div>		<div>Abwickl. Gesamt/dev. drawing all(mm)</div> <div>-</div>			
					<div>Datum Date</div>	<div>Name Name</div>	<div>Benennung/Designation</div> <div>Varimaxx SG 90-137 (4-teilig)</div>						
				<div>Bearb. Drawn</div>	<div>17.12.2013</div>	<div>M. Kleinhans</div>							
				<div>Gepr. Check.</div>	<div>17.12.2013</div>	<div>M. Kleinhans</div>							
				<div>Norm Appr.</div>									
				<div>Artikel-Nr./Piecie No.</div>			<div>Zeichnungs-Nr./Part-No.</div> <div>-</div>					<div>Blatt Sheet</div>	<div>1</div>
				<div>-</div>								<div>von of</div>	<div>1</div>
<div>-</div>	<div>-</div>	<div>-</div>	<div>-</div>										
<div>Ausg. Issue</div>	<div>Änderung Modification</div>	<div>Datum Date</div>	<div>Name Name</div>	<div>Dateiname Filename</div>	<div>SG 90 137.prt</div>		<div>Ursprung Source</div>	<div>-</div>			<div>A4</div>		